

- NOTES:**
1. THE (NAD83) TIDAL ELEVATION DATA DEPICTED IS DERIVED FROM OPPOSITE ENDS OF THE FJORD TRAIL (BEACON / COLD SPRING) WHICH SUGGEST A SLIGHT FLUCTUATION BETWEEN TIDE STATIONS ALONG THE HUDSON RIVER. NORMAL TIDE ELEVATIONS (EXCLUDING EXTREME ASTRONOMICAL TIDES) RANGE BETWEEN APPROXIMATELY +1.75 AND -1.45. THE TIDAL INFORMATION IN THE SECTIONS BELOW IS AVERAGED FROM ELEVATIONS AT COLD SPRING AND BEACON FROM THE ONLINE VERSION OF NOAA'S DATUM SOFTWARE AT LOCATIONS ADJACENT TO EACH TOWN USING DATUM'S ONLINE MAP. COLD SPRING, NY: "LATITUDE 41.41656 N, LONGITUDE -073.965229 W SOURCE: VDATUM.NOAA.GOV/VDATUMWEB/".
 2. SECTIONS ARE SHOWN TO DEPICT RELATIONSHIPS BETWEEN PROPOSED ELEMENTS. REFER TO ASSEMBLY AND DETAIL DRAWINGS FOR MORE INFORMATION. THE SECTIONS AND DETAILS ARE TO BE UTILIZED IN CONCERT TO FULLY INTERPRET THE DESIGN INTENT. THE CONTRACTOR SHALL SEEK CLARIFICATION FROM THE LANDSCAPE ARCHITECT IN THE EVENT OF ANY DISCREPANCIES BETWEEN THE SECTIONS AND DETAILS.
 3. ALL GRADING INFORMATION IS SHOWN FOR REFERENCE ONLY. SEE CIVIL DRAWINGS FOR GRADING PLANS.
 4. SEE CIVIL PLANS FOR SOIL EMBANKMENT AND STABILIZATION REQUIREMENTS.
 5. SEE STRUCTURAL PLANS FOR ADDITIONAL INFORMATION.
 6. SEE L-001 FOR ADDITIONAL NOTES.

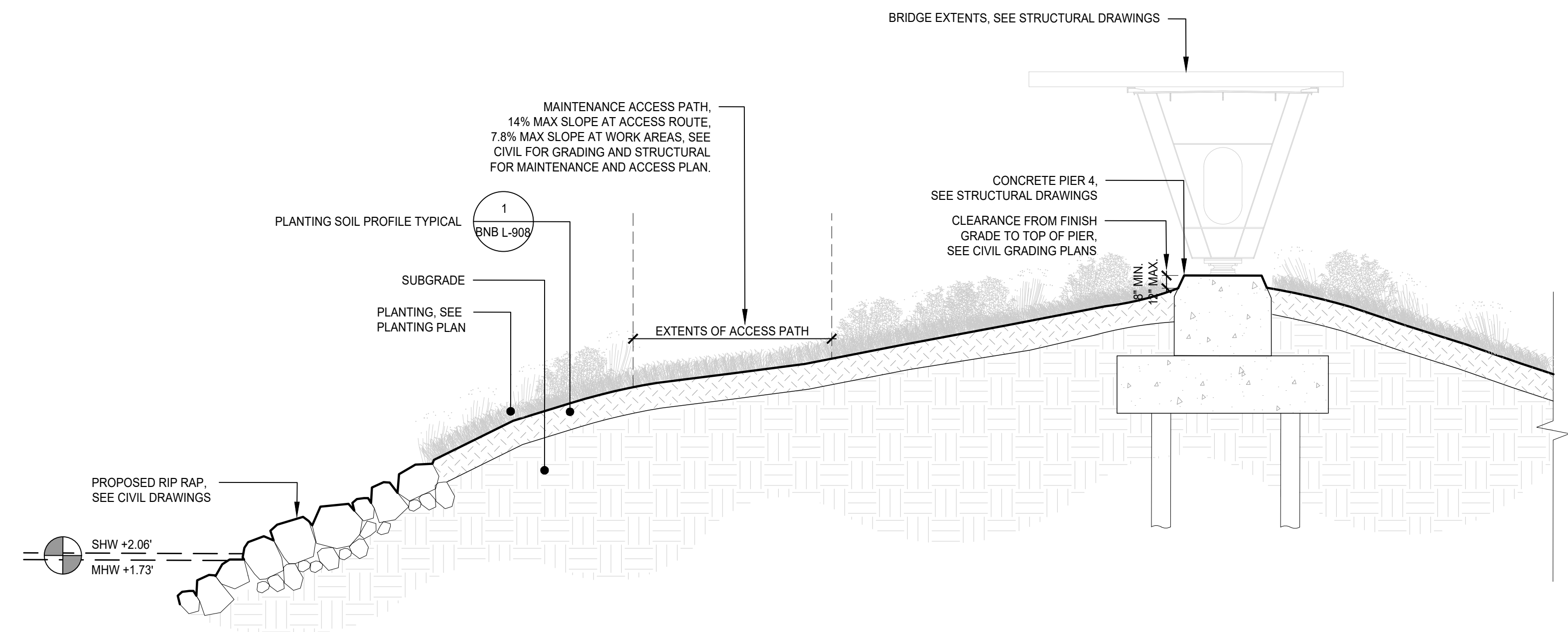

2 SECTION PIER 4 WEST
SCALE: 1" = 5'

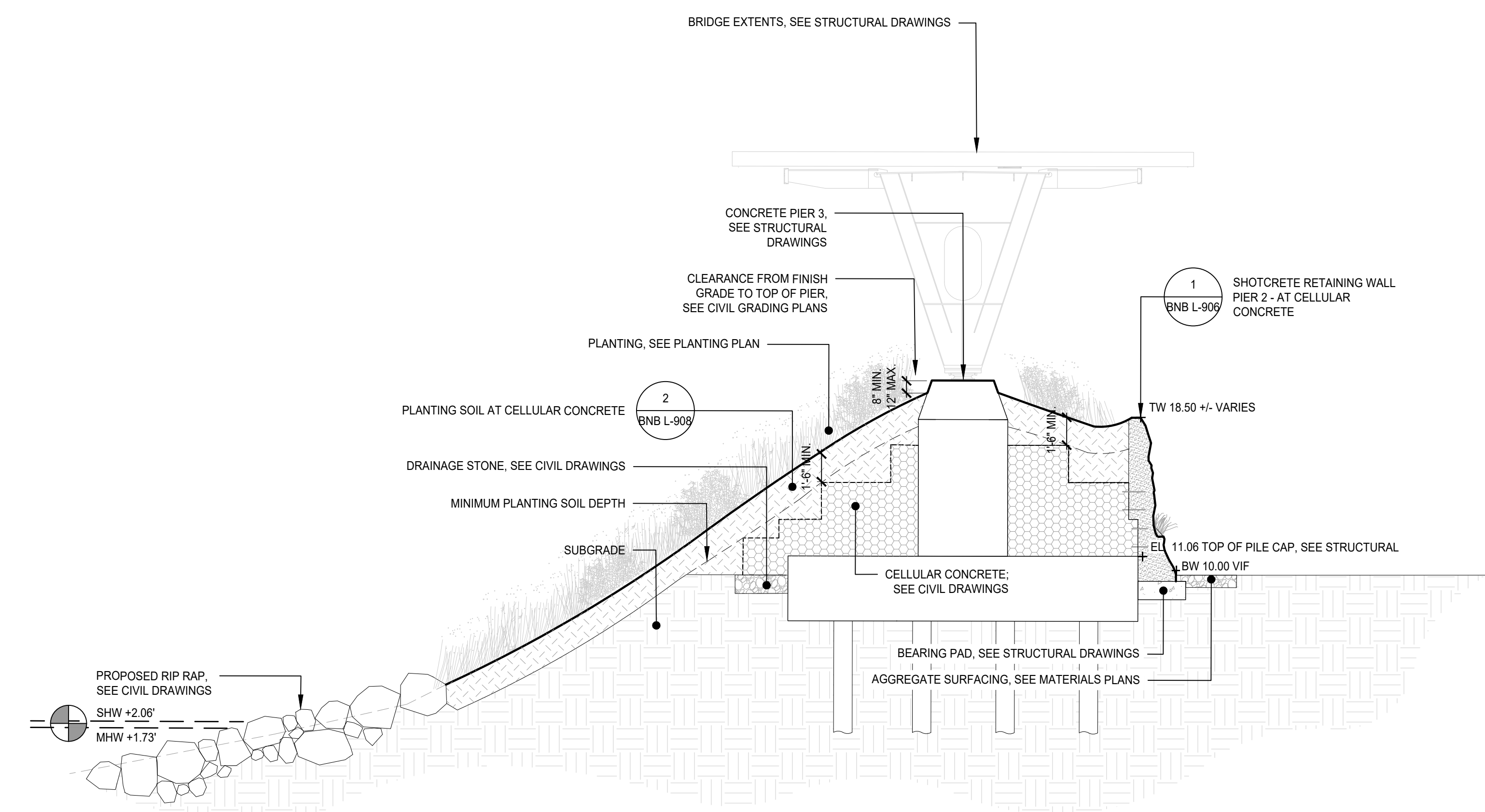

1 SECTION PIER 3 WEST
SCALE: 1" = 5'

Governor Kathy Hochul	Commissioner Erik Kulleseid	
<small>IT IS A VIOLATION OF STATE EDUCATION LAW FOR ANY PERSON, UNLESS UNDER THE DIRECTION OF A LICENSED ARCHITECT/ENGINEER TO ALTER THIS DOCUMENT IN ANY WAY. ALTERATIONS MUST HAVE THE SEAL, AFFIXED ALONG WITH A DESCRIPTION OF THE ALTERATIONS, DATE AND ARCHITECT/ENGINEER'S SIGNATURE. COPYRIGHT © 2015.</small>		
Client HUDSON HIGHLANDS FJORD TRAIL ONE CIVIC CENTER PLAZA, SUITE 200 Poughkeepsie, NY 12601		
Client Representative ABOUT THE WORK 40 EXCHANGE PLACE, SUITE 1708, NEW YORK, NY 10005		
Structural & Electrical Engineer of Record ARUP US, INC. 77 WATER ST. NEW YORK, NEW YORK 10005		
Landscape Architect SCAPE LANDSCAPE ARCHITECTURE DPC 277 BROADWAY 9TH FLOOR, NEW YORK, NY 10007		
Survey BADEY & WATSON 3036 ROUTE 9, COLD SPRING, NY 10516		
Architect GRAY ORGANSCHI ARCHITECTURE 35 CROWN STREET, NEW HAVEN, CT 06510		
Civil, Traffic, Geotech & Permitting Engineer LANGAN 360 WEST 31ST STREET, 8TH FL., NEW YORK, NY 10001		
Structural Scheme Design FAST + EPP 411 EAST 11TH STREET, 11TH FLOOR, NEW YORK, NY 10003		
Project Title: The Hudson Highlands Fjord Trail Breakneck Bridge Name of Region: Dutchess County New York Project Location: Town of Fishkill Dutchess County New York		
Contract Numbers GC Contract Number: D- HVAC Contract Number: D- Plumbing Contract Number: D- Electrical Contract Number: D-		
REVISIONS		
Rev. No	Description	Date
	100% CONSTRUCTION DOCUMENTS	08/23/2023
Drawn By:	SCAPE	Seal and Signature
Design By:	SCAPE	
Checked By:	SCAPE	
Approved By:	SCAPE	
Date:	08/23/2023	
Sheet Title:	SITE SECTIONS	Drawing Number: BNB L-800
Project Number:	288206	Scale: AS NOTED

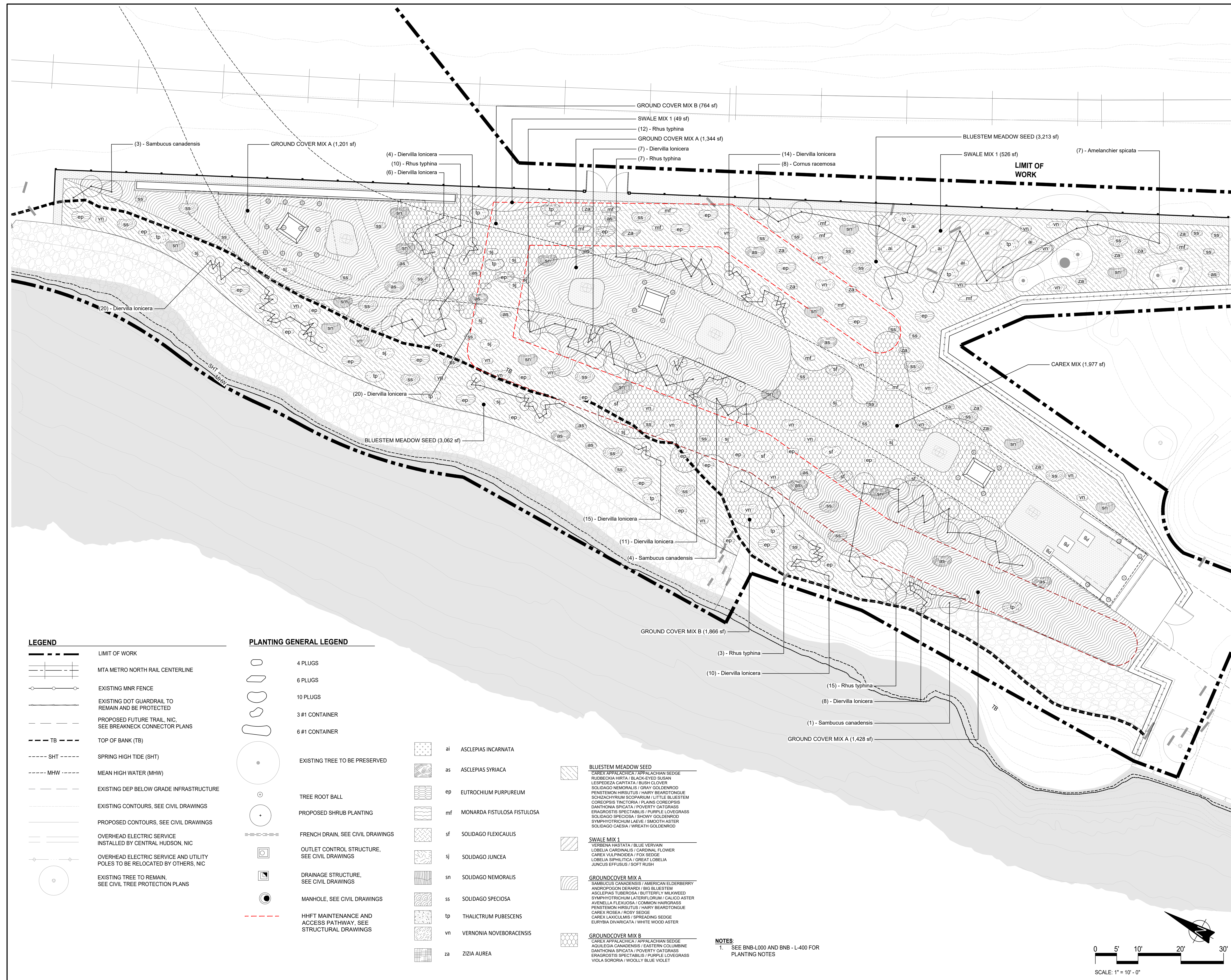

Governor Kathy Hochul
Commissioner Erik Kulleseid

Client: HUDSON HIGHLANDS FJORD TRAIL
ONE CIVIC CENTER PLAZA, SUITE 200
POUGHKEEPSIE, NY 12601

Client Representative: ABOUT THE WORK
40 EXCHANGE PLACE, SUITE 1708, NEW YORK, NY 10005

Structural & Electrical Engineer of Record: ARUP US, INC.
77 WATER ST. NEW YORK, NEW YORK 10005

Landscape Architect: SCAPE LANDSCAPE ARCHITECTURE DPC
277 BROADWAY 9TH FLOOR, NEW YORK, NY 10007

Survey: BADEY & WATSON
3036 ROUTE 9, COLD SPRING, NY 10516

Architect: GRAY ORGANSCHI ARCHITECTURE
35 CROWN STREET, NEW HAVEN, CT 06510

Civil, Traffic, Geotech & Permitting Engineer: LANGAN
360 WEST 31ST STREET, 8TH FL., NEW YORK, NY 10001

Structural Scheme Design: FAST + EPP
411 EAST 11TH STREET, 11TH FLOOR, NEW YORK, NY 10003

Project Title: The Hudson Highlands Fjord Trail Breakneck Bridge
Name of Region: Dutchess County New York
Project Location: Town of Fishkill Dutchess County New York

Contract Numbers
GC Contract Number: D-
HVAC Contract Number: D-
Plumbing Contract Number: D-
Electrical Contract Number: D-

REVISIONS		
Rev. No	Description	Date
	100% CONSTRUCTION DOCUMENTS	08/23/2023

Drawn By: SCAPE
Design By: SCAPE
Checked By: SCAPE
Approved By: SCAPE
Date: 08/23/2023

Sheet Title: PLANTING PLAN
Drawing Number: BNB L-401

Project Number: 288206
Scale: AS NOTED

- LEGEND**
- LIMIT OF WORK
 - MTA METRO NORTH RAIL CENTERLINE
 - EXISTING MNR FENCE
 - EXISTING DOT GUARDRAIL TO REMAIN AND BE PROTECTED
 - PROPOSED FUTURE TRAIL, NIC, SEE BREAKNECK CONNECTOR PLANS
 - TOP OF BANK (TB)
 - SPRING HIGH TIDE (SHT)
 - MEAN HIGH WATER (MHW)
 - EXISTING DEP BELOW GRADE INFRASTRUCTURE
 - EXISTING CONTOURS, SEE CIVIL DRAWINGS
 - PROPOSED CONTOURS, SEE CIVIL DRAWINGS
 - OVERHEAD ELECTRIC SERVICE INSTALLED BY CENTRAL HUDSON, NIC
 - OVERHEAD ELECTRIC SERVICE AND UTILITY POLES TO BE RELOCATED BY OTHERS, NIC
 - EXISTING TREE TO REMAIN, SEE CIVIL TREE PROTECTION PLANS
- PLANTING GENERAL LEGEND**
- 4 PLUGS
 - 6 PLUGS
 - 10 PLUGS
 - 3 #1 CONTAINER
 - 6 #1 CONTAINER
 - EXISTING TREE TO BE PRESERVED
 - TREE ROOT BALL
 - PROPOSED SHRUB PLANTING
 - FRENCH DRAIN, SEE CIVIL DRAWINGS
 - OUTLET CONTROL STRUCTURE, SEE CIVIL DRAWINGS
 - DRAINAGE STRUCTURE, SEE CIVIL DRAWINGS
 - MANHOLE, SEE CIVIL DRAWINGS
 - HHFT MAINTENANCE AND ACCESS PATHWAY, SEE STRUCTURAL DRAWINGS
- PLANTING CODES**
- ai ASCLEPIAS INCARNATA
 - as ASCLEPIAS SYRIACA
 - ep EUTROCHUM PURPUREUM
 - mf MONARDA FISTULOSA FISTULOSA
 - sf SOLIDAGO FLEXICAULUS
 - sj SOLIDAGO JUNCEA
 - sn SOLIDAGO NEMORALIS
 - ss SOLIDAGO SPECIOSA
 - tp THALICTRUM PUBESCENS
 - vn VERNONIA NOVEBORACENSIS
 - za ZIZIA AUREA
- BLUESTEM MEADOW SEED**
CAREX APPALACHICA / APPALACHIAN SEDGE
RUBICEKIA HIRTA / BLACK-EYED SUSAN
LESPEDEZA CAPITATA / BUSH CLOVER
SOLIDAGO NEMORALIS / GRAY GOLDENROD
PENSTEMON HIRSUTUS / HARRY BEARDTONGUE
SOLIDAGO VIRIDIS / LITTLE BLUESTEM
COREOPSIS TINCTORIA / PLAINS COREOPSIS
DANTHONIA SPICATA / POVERTY CATGRASS
ERAGROSTIS SPECTABILIS / PURPLE LOVEGRASS
SOLIDAGO SPECIOSA / SHOWY GOLDENROD
SYMPHYOTRICHUM LAEVE / SMOOTH ASTER
SOLIDAGO CAESIA / WREATH GOLDENROD
- SWALE MIX 1**
VERBENA FASTATA / BLUE VERRYAN
LOBELIA CARDINALIS / CARDINAL FLOWER
CAREX VULPINOIDEA / FOX SEDGE
LOBELIA SIPHILITICA / GREAT LOBELIA
JUNCUS EFFUSUS / SOFT RUSH
- GROUND COVER MIX A**
SAMBUCUS CANADENSIS / AMERICAN ELDERBERRY
ANDROPOGON DERARDI / BIG BLUESTEM
ASCLEPIAS TUBEROSA / BUTTERFLY MILKWEED
SYMPHYOTRICHUM LATERIFLORUM / CALICO ASTER
AVENELLA FLEXUOSA / COMMON HARRIGRASS
PENSTEMON HIRSUTUS / HARRY BEARDTONGUE
CAREX ROSEA / ROSY SEDGE
CAREX LACINULIS / SPREADING SEDGE
EURYBIA DIVARICATA / WHITE WOOD ASTER
- GROUND COVER MIX B**
CAREX APPALACHICA / APPALACHIAN SEDGE
AQUILEGIA CANADENSIS / EASTERN COLUMBINE
DANTHONIA SPICATA / POVERTY CATGRASS
ERAGROSTIS SPECTABILIS / PURPLE LOVEGRASS
VIOLA SORORIA / WOOLLY BLUE VIOLET

NOTES
1. SEE BNB-L000 AND BNB-L-400 FOR PLANTING NOTES

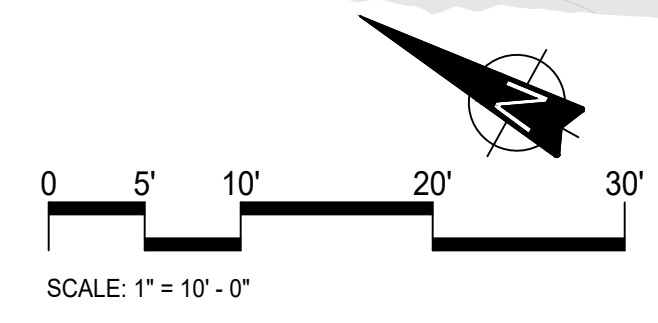

PLANTING SCHEDULE								
SHRUBS	QUANTITY	CODE	BOTANICAL	COMMON	SIZE	CONDITION	SPACING	NOTES
	8		AMELANCHIER SPICATA	DWARF SERVICEBERRY	#3	CONT.	AS SHOWN	FULL SPECIMEN
	9		CORNUS RACEMOSA	GRAY DOGWOOD	#3	CONT.	AS SHOWN	FULL SPECIMEN
	96		DIERVILLA LONICERA	DWARF BUSH HONEYSUCKLE	#3	CONT.	AS SHOWN	FULL SPECIMEN
	49		RHUS TYPHINA	STAGHORN SUMAC	#3	CONT.	AS SHOWN	FULL SPECIMEN
	9		SAMBUCUS CANADENSIS	AMERICAN ELDERBERRY	#3	CONT.	AS SHOWN	FULL SPECIMEN
PERRENIALS	QUANTITY	CODE	BOTANICAL	COMMON	SIZE	CONDITION	SPACING	NOTES
	123	ai	ASCLEPIAS INCARNATA	SWAMP MILKWEED	PLUG	PLUG	12" O.C.	FULL PLANTS EVENLY DISTRIBUTED
	110	as	ASCLEPIAS SYRIACA	COMMON MILKWEED	PLUG	PLUG	12" O.C.	FULL PLANTS EVENLY DISTRIBUTED
	27		AVENELLA FLEXUOSA	COMMON HAIRGRASS	#2	CONT.	AS SHOWN	SEE L-402
	265	ep	EUTROCHIIUM PURPUREUM	JOE PYE WEED	PLUG	PLUG	12" O.C.	FULL PLANTS EVENLY DISTRIBUTED
	62	mf	MONARDA FISTULOSA FISTULOSA	WILD BERGAMOT	PLUG	PLUG	12" O.C.	FULL PLANTS EVENLY DISTRIBUTED
	46		PANICUM VIRGATUM	SWITCH GRASS	#2	CONT.	AS SHOWN	SEE L-402
	55	sf	SOLIDAGO FLEXICAULIS	ZIGZAG GOLDENROD	PLUG	PLUG	12" O.C.	FULL PLANTS EVENLY DISTRIBUTED
	82	sj	SOLIDAGO JUNCEA	EARLY GOLDENROD	PLUG	PLUG	12" O.C.	FULL PLANTS EVENLY DISTRIBUTED
	150	sn	SOLIDAGO NEMORALIS	GRAY GOLDENROD	PLUG	PLUG	12" O.C.	FULL PLANTS EVENLY DISTRIBUTED
	250	ss	SOLIDAGO SPECIOSA	SHOWY GOLDENROD	PLUG	PLUG	12" O.C.	FULL PLANTS EVENLY DISTRIBUTED
	120	tp	THALICTRUM PUBESCENS	TALL MEADOW RUE	PLUG	PLUG	12" O.C.	FULL PLANTS EVENLY DISTRIBUTED
	167	vn	VERNONIA NOVEBORACENSIS	COMMON IRONWEED	PLUG	PLUG	12" O.C.	FULL PLANTS EVENLY DISTRIBUTED
	64	za	ZIZIA AUREA	GOLDEN ALEXANDER	PLUG	PLUG	12" O.C.	FULL PLANTS EVENLY DISTRIBUTED

PERRENIAL MIXES								
BLUESTEM MEADOW SEED MIX	QUANTITY	% FILL	BOTANICAL	COMMON	SIZE	CONDITION	SPACING	NOTES
	628 SF	10%	CAREX APPALACHICA	APPALACHIAN SEDGE	SEED	SEED		SEED AT 40 LBS/ ACRE PER SPECIFICATIONS
	314 SF	5%	COREOPSIS TINCTORIA	PLAINS COREOPSIS	SEED	SEED		SEED AT 40 LBS/ ACRE PER SPECIFICATIONS
	941 SF	15%	DANTHONIA SPICATA	POVERTY OATGRASS	SEED	SEED		SEED AT 40 LBS/ ACRE PER SPECIFICATIONS
	314 SF	5%	ERAGROSTIS SPECTABILIS	PURPLE LOVEGRASS	SEED	SEED		SEED AT 40 LBS/ ACRE PER SPECIFICATIONS
	314 SF	5%	LESPEDAZA CAPITATA	BUSH CLOVER	SEED	SEED		SEED AT 40 LBS/ ACRE PER SPECIFICATIONS
	188 SF	3%	PENSTEMON HIRSUTUS	HAIRY BEARDTONGUE	SEED	SEED		SEED AT 40 LBS/ ACRE PER SPECIFICATIONS
	314 SF	5%	RUDBECKIA HIRTA	BLACK-EYED SUSAN	SEED	SEED		SEED AT 40 LBS/ ACRE PER SPECIFICATIONS
	3138 SF	50%	SCHIZACHYRIUM SCOPARIUM	LITTLE BLUESTEM	SEED	SEED		SEED AT 40 LBS/ ACRE PER SPECIFICATIONS
	126 SF	2%	SOLIDAGO CAESIA	WREATH GOLDENROD	SEED	SEED		SEED AT 40 LBS/ ACRE PER SPECIFICATIONS
	314 SF	5%	SOLIDAGO NEMORALIS	GRAY GOLDENROD	SEED	SEED		SEED AT 40 LBS/ ACRE PER SPECIFICATIONS
	314 SF	5%	SYMPHYOTRICHUM LAEVE	SMOOTH ASTER	SEED	SEED		SEED AT 40 LBS/ ACRE PER SPECIFICATIONS
SWALE MIX 1								
	299	50%	CAREX VULPINOIDEA	FOX SEDGE	PLUG	DP50	12" O.C.	FULL PLANTS EVENLY DISTRIBUTED
	48	8%	JUNCUS EFFUSUS	SOFT RUSH	PLUG	DP50	12" O.C.	FULL PLANTS EVENLY DISTRIBUTED
	36	6%	LOBELIA CARDINALIS	CARDINAL FLOWER	#1	CONT.	12" O.C.	FULL PLANTS EVENLY DISTRIBUTED
	60	10%	LOBELIA SIPHILITICA	GREAT LOBELIA	#1	CONT.	12" O.C.	FULL PLANTS EVENLY DISTRIBUTED
	60	10%	VERBENA HASTATA	BLUE VERVAIN	PLUG	DP50	12" O.C.	FULL PLANTS EVENLY DISTRIBUTED
GROUND COVER MIX A								
	207	5%	ANDROPOGON DERARDI	BIG BLUESTEM	PLUG	DP50	12" O.C.	FULL PLANTS EVENLY DISTRIBUTED
	413	10%	ASCLEPIAS TUBEROSA	BUTTERFLY MILKWEED	PLUG	DP50	12" O.C.	FULL PLANTS EVENLY DISTRIBUTED
	826	45%	AVENELLA FLEXUOSA	COMMON HAIRGRASS	#1	CONT.	12" O.C.	FULL PLANTS EVENLY DISTRIBUTED
	207	5%	CAREX LAXICULMIS	SPREADING SEDGE	PLUG	DP50	12" O.C.	FULL PLANTS EVENLY DISTRIBUTED
	929	10%	CAREX ROSEA	ROSY SEDGE	PLUG	PLUG	8" O.C.	FULL PLANTS EVENLY DISTRIBUTED
	207	5%	EURYBIA DIVARICATA	WHITE WOOD ASTER	PLUG	DP50	12" O.C.	FULL PLANTS EVENLY DISTRIBUTED
	413	10%	PENSTEMON HIRSUTUS	HAIRY BEARDTONGUE	PLUG	DP50	12" O.C.	FULL PLANTS EVENLY DISTRIBUTED
	207	5%	SAMBUCUS CANADENSIS	AMERICAN ELDERBERRY	#3	CONT.	12" O.C.	FULL PLANTS EVENLY DISTRIBUTED
	207	5%	SYMPHYOTRICHUM LATERIFLORUM	CALICO ASTER	PLUG	DP50	12" O.C.	FULL PLANTS EVENLY DISTRIBUTED
GROUND COVER MIX B								
	820	30%	CAREX APPALACHICA	APPALACHIAN SEDGE	PLUG	DP50	12" O.C.	FULL PLANTS EVENLY DISTRIBUTED
	137	5%	AQUILEGIA CANADENSIS	EASTERN COLUMBINE	PLUG	DP51	12" O.C.	FULL PLANTS EVENLY DISTRIBUTED
	274	10%	DANTHONIA SPICATA	POVERTY OATGRASS	PLUG	DP52	12" O.C.	FULL PLANTS EVENLY DISTRIBUTED
	1367	50%	ERAGROSTIS SPECTABILIS	PURPLE LOVEGRASS	PLUG	DP53	12" O.C.	FULL PLANTS EVENLY DISTRIBUTED
	137	5%	VIOLA SORORIA	WOOLLY BLUE VIOLET	PLUG	DP54	12" O.C.	FULL PLANTS EVENLY DISTRIBUTED
GROUND COVER MIX C								
	50	50%	CAREX APPALACHICA	APPALACHIAN SEDGE	PLUG	DP50	6" O.C.	FULL PLANTS EVENLY DISTRIBUTED
	50	50%	JUNCUS TEUNIS	PATH RUSH	PLUG	DP51	6" O.C.	FULL PLANTS EVENLY DISTRIBUTED

PLANTING NOTES:

- PLANT LIST & NURSERY SOURCES TO BE APPROVED BY NYS O.P.R.H.P. PRIOR TO PROCUREMENT.
- COORDINATE & REFER TO SOILS PLANS' PROFILES & SPECIFICATIONS FOR INFORMATION REGARDING PLANTING BED PREPARATION.
- COORDINATE & REFER TO PROTECTION & REMOVALS PLANS FOR INFORMATION REGARDING THE REMOVAL OF INVASIVE SPECIES & PROTECTION OF EXISTING PLANTINGS ON SITE.
- PLANTING MATERIAL TO BE CONTRACT GROWN BY NURSERY(S) EXPERIENCED IN CONSERVATION & RESTORATION.
- CONTRACTOR TO ENSURE PLANTS ARE STRAIGHT SPECIES. NO CULTIVARS WILL BE ACCEPTED. SUBSTITUTIONS OF PLANT ANY PLANTING MATERIAL REQUIRES EXPRESS WRITTEN APPROVAL BY LANDSCAPE ARCHITECT.
- THE CONTRACTOR SHALL TAKE EXTREME CARE TO PROTECT THE ROOT SYSTEMS OF EXISTING TREES. HAND/PIECE EXCAVATE WITHIN THE DRIPLINES OF EXISTING TREES.
- ANY PLANTS REMAINING UNPLANTED ON THE SITE FOR MORE THAN 24 HOURS SHALL BE PROTECTED AND MAINTAINED INCLUDING BUT NOT LIMITED TO WATER AND SHADE. ANY DAMAGED PLANTS SHALL BE REPLACED AS DIRECTED, AT THE CONTRACTOR'S EXPENSE.
- PRIOR TO COMMENCING PLANTING, THE CONTRACTOR SHALL STAKE OUT THE EXACT LOCATION OF THE ALL TREES FOR THE LANDSCAPE ARCHITECT'S APPROVAL. ALL PLANTING OPERATIONS AND LAYOUT SHALL PROCEED UNDER CLOSE COORDINATION WITH THE LANDSCAPE ARCHITECT. TREE LOCATIONS MAY VARY AS DIRECTED BY THE LANDSCAPE ARCHITECT IN THE FIELD. THE ACTUAL LOCATION OF PLANT MATERIALS MAY VARY DUE TO FIELD CONDITIONS. FINAL PLACEMENT OF PLANT MATERIAL SHALL BE APPROVED BEFORE PITS ARE DIG. IF INITIAL PLACEMENT IS NOT SATISFACTORY, PLANTS SHALL BE RELOCATED IN THE FIELD AT THE DIRECTION OF THE LANDSCAPE ARCHITECT, AT NO ADDITIONAL COST TO THE OWNER.
- MATERIAL WILL BE INSPECTED AND APPROVED AT PLACE OF GROWTH BY THE LANDSCAPE ARCHITECT. HOWEVER, PLANT MATERIAL WHICH HAS BECOME DAMAGED OR DISEASED OR WHICH IS UNACCEPTABLE TO THE LANDSCAPE ARCHITECT MAY BE REJECTED UPON DELIVERY TO THE SITE.
- SHOULD THERE BE ANY DISCREPANCIES BETWEEN THE QUANTITIES CALLED FOR ON THE PLANT LIST AND THOSE INDICATED ON THE PLAN, THE GREATER QUANTITY SHALL GOVERN.
- AT ALL TIMES, THE SITE SHALL BE KEPT NEAT AND FREE OF DEBRIS LEFT FROM THE PLANTING OPERATION.
- ALL PLANT MATERIAL TO BE VIGOROUS, AND FREE OF INJURY OR DEFECTS. ALL PLANT MATERIAL TO BE TRUE REPRESENTATIVES OF THEIR SPECIES.
- ALL PLANT TAGS MUST REMAIN ON THE PLANT MATERIAL UNTIL THE LANDSCAPE ARCHITECT REVIEWS THE LAYOUT AND APPROVES QUANTITIES. DO NOT REMOVE PRIOR TO ACCEPTANCE OF PUNCH LIST.

Governor Kathy Hochul Commissioner Erik Kulleseid

IT IS A VIOLATION OF STATE EDUCATION LAW FOR ANY PERSON, UNLESS UNDER THE DIRECTION OF A LICENSED ARCHITECT/ENGINEER TO ALTER THIS DOCUMENT IN ANY WAY. ALTERATIONS MUST HAVE THE SEAL, AFFIXED ALONG WITH A DESCRIPTION OF THE ALTERATIONS, DATE AND ARCHITECT/ENGINEER'S SIGNATURE. COPYRIGHT © 2015

Client
Hudson Highlands Fjord Trail
ONE CIVIC CENTER PLAZA, SUITE 200
POUGHKEEPSIE, NY 12601



Client Representative
ABOUT THE WORK
40 EXCHANGE PLACE, SUITE 1708, NEW YORK, NY 10005



Structural & Electrical Engineer of Record
ARUP US, INC.
77 WATER ST. NEW YORK, NEW YORK 10005



Landscape Architect
SCAPE LANDSCAPE ARCHITECTURE DPC
277 BROADWAY 9TH FLOOR, NEW YORK, NY 10007



Survey
BADEY & WATSON
3036 ROUTE 9, COLD SPRING, NY 10516

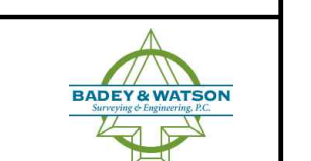

Architect
GRAY ORGANSCHI ARCHITECTURE
35 CROWN STREET, NEW HAVEN, CT 06510



Civil, Traffic, Geotech & Permitting Engineer
LANGAN
360 WEST 31ST STREET, 8TH FL, NEW YORK, NY 10001



Structural Scheme Design
FAST + EPP
411 EAST 11TH STREET, 11TH FLOOR, NEW YORK, NY 10003



Project Title: The Hudson Highlands Fjord Trail Breakneck Bridge
Name of Region: Dutchess County New York
Project Location: Town of Fishkill Dutchess County New York

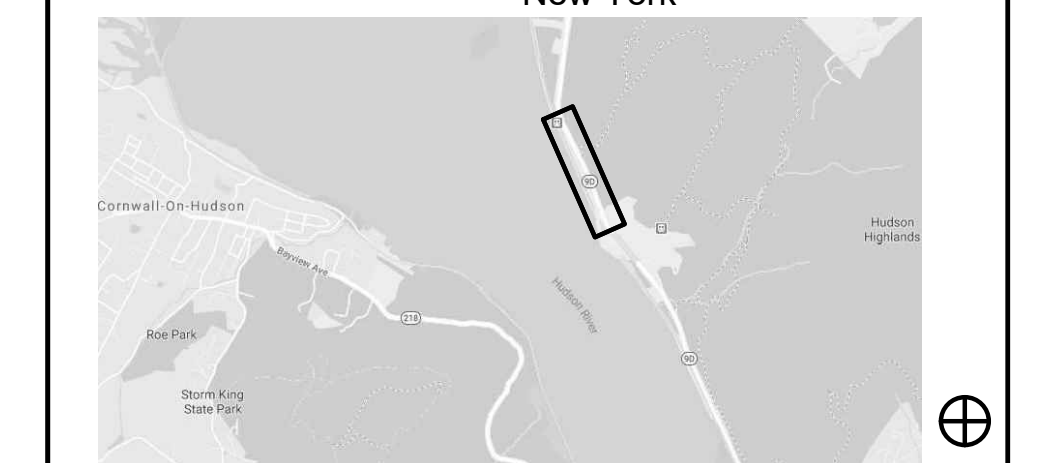

Contract Numbers
GC Contract Number: D-
HVAC Contract Number: D-
Plumbing Contract Number: D-
Electrical Contract Number: D-

REVISIONS		
Rev. No	Description	Date
	100% CONSTRUCTION DOCUMENTS	08/23/2023

Drawn By: **SCAPE** Seal and Signature
Design By: **SCAPE**
Checked By: **SCAPE**
Approved By: **SCAPE**
Date: **08/23/2023**
Sheet Title: **PLANTING SCHEDULE** Drawing Number: **BNB L-400**
Project Number: **288206** Scale: **AS NOTED**